



APPLICATION:

### Cables Through Rigid Floors

ID:

IS:SP-RF-E-01

**INFORMATION:**

- Not to scale
- All units are in millimetres
- Tested according EN 1366-3
- [Approval ETA-10/0406](#)

### CFS-IS Intumescent Sealant

REV:

DATE:

01

10/2024

### Fire Rating up to EI 120

Page 2/2

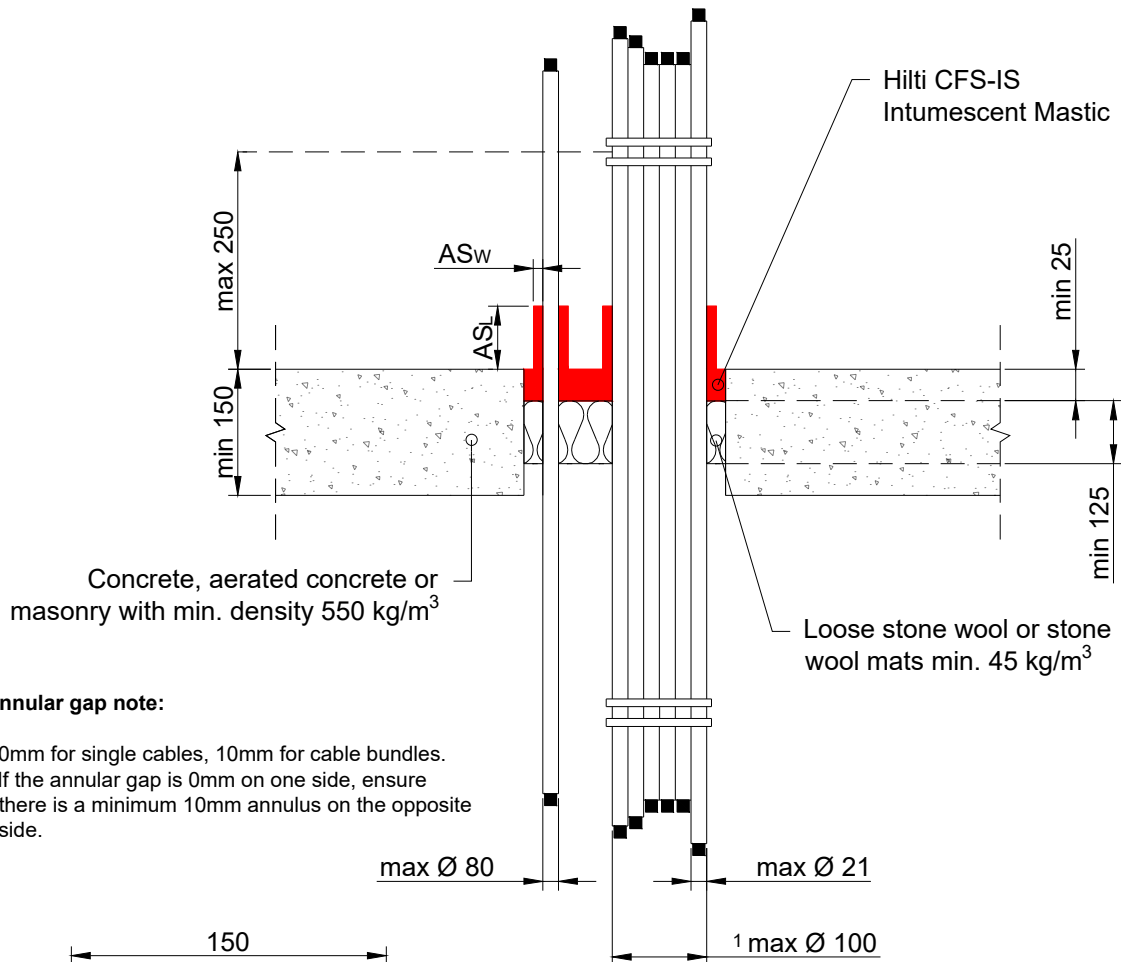

**Annular gap note:**

- 0mm for single cables, 10mm for cable bundles.
- If the annular gap is 0mm on one side, ensure there is a minimum 10mm annulus on the opposite side.

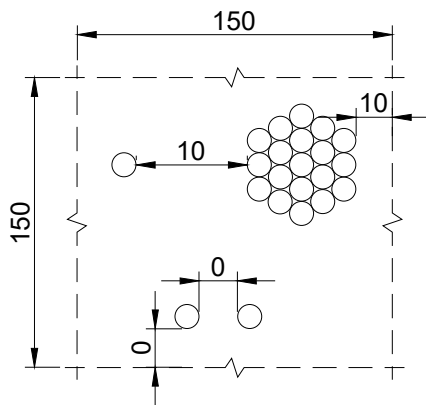

Max opening size 150mm x 150mm or circular openings of equivalent area (Ø 165 mm). Min 100mm distance to other firestopping penetrations. Min. 200mm to other penetrations (e.g., doors, windows etc.)

Cable Type / Ø	AS <sub>w</sub>	AS <sub>L</sub>	Classification
Max. Ø21	10	50	EI 120
	10	100	EI 120
	0	0	EI 120
21 ≤ Ø 80	10	50	EI 90
	10	100	EI 120
	0	0	EI 90
<sup>1</sup> Tied cable bundle of max. Ø100, with max. single cable Ø21	10	50	EI 120
	10	100	EI 120
	0	0	EI 90

All sheathed cable types currently and commonly used in building practice in Europe (e.g., power, control, signal, telecommunication, data, optical fibre)

1. The application limits on this detail are for guidance purposes only. For more detailed information based on the full range of available test results please contact the Hilti Technical Advisory Service.  
 2. The product and application has been assessed as a minimum to the BS 476 standard. It may have additional European and worldwide testing. Please contact Hilti for further information.  
 3. All installations should be carried out in accordance with Hilti's installation instructions and by competent & experienced installers using Hilti branded products.  
 4. All services are to be correctly and adequately supported to prevent collapse and distortion.